

**FOREMAN** Athletic Locker - Model: TENNIS DOUBLE 71" High

INTERIOR VIEW  
WITHOUT DOOR

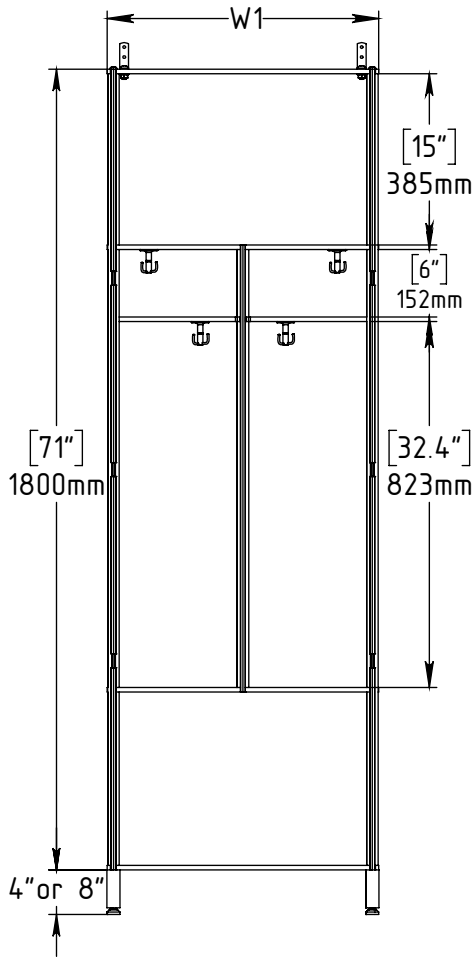

SIDE VIEW

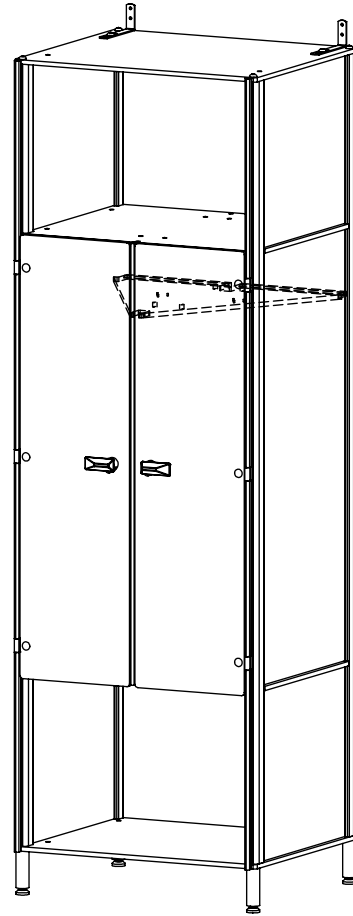
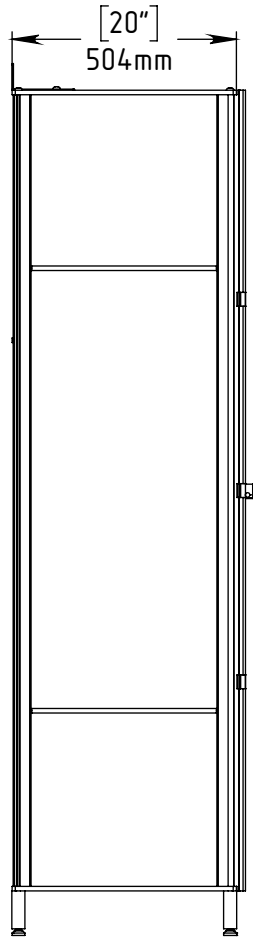

TOP VIEW

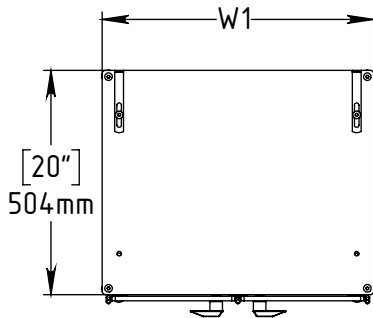

**AVAILABLE WIDTHS**

OA Width	24"	28"	30"	32"
	610mm	711mm	762mm	813mm

**FOREMAN**  
locker systems

PROPRIETARY AND CONFIDENTIAL	DESCRIPTION	NAME	DATE
THE INFORMATION CONTAINED IN THIS DRAWING IS THE SOLE PROPERTY OF FOREMAN PRODUCTS LLC. ANY REPRODUCTION IN PART OR AS A WHOLE WITHOUT THE WRITTEN PERMISSION OF FOREMAN PRODUCTS LLC IS PROHIBITED	Athletic Locker - Model: TENNIS DOUBLE 71" High	DRAWN BY	KB 01.01.2020
	--	MRG APPR.	NB --
	SCALE: --	Page 1 of 2	

Our athletic lockers feature durable and versatile structural elements to ensure long-lasting use. Each model offering convenient upper and lower storage available in multiple design variations to meet the needs of every athlete.

## DESIGN

•Single Unit with (2) Compartment Cabinet Style Doors, (1) Full Size Upper Cubby and (1) Full Size Lower Cubby

\*All models may be customized to match individual design specifications.

## STANDARD CONSTRUCTION ELEMENTS

\*measurements expressed in (inches or ")

**Dimensions:** Width: 18", 24" | Depth: 18" | Height: 72"

**Door Opening:** 180° with 6063 T6 Aluminum Anodized Profile Integrated Hinges

**Body Material:** High Pressure Laminate ; Stainless Steel Hardware

**Material Thickness:** Top, Bottom, Shelves, Sides: 3/8" ; Back: 5/16"

## FEATURES

- **Water Resistant & Non-Corroding-** Built to withstand water exposure, making them ideal for humid environments such as aquatic centers, swimming pools, and showers.
- **Indoor / Outdoor Use-** Built to withstand heavy impact, scratches, graffiti, and chemicals. Optional UV protected panels are available for outdoor use.
- **Ventilation-** 360° 3mm gap around doors for increased ventilation.
- **Hooks-** (2) 3 Prong Hooks per locker compartment.
- **High-End Customization Options-** Optional features include tempered glass and side-mounted aluminum channels for hard-wired RFID locks and conveniently placed USB chargers and/or LED lighting.
- **Unique Cabinet Style Locker Design-** Unique double door cabinet style design for shared or personal use.
- **Adjustable Legs-** 4" or 8" extruded aluminum legs with up to 1" adjustability.
- **Stock Colors -** Choose from a curated list of our most popular color options by leading phenolic suppliers. \*Choosing from our stock colors may help expedite lead times.
- **Extensive Lock Options-** We provide a wide selection of lock types and can integrate additional lock options to meet specific requirements.
- **Number Plates-** Adhesive mounted 3M brushed aluminum plates with black etched reveal.
- **Ships Assembled-** Athletic Lockers arrive pre-assembled for quick, hassle-free installation, ensuring consistent quality, and structural integrity.
- **Filler and Toe Kick Panels-** Filler panels close gaps between lockers and walls for a seamless, professional finish, while toe kick panels cover the space beneath lockers, preventing dirt accumulation and providing a polished, clean look to the installation.
- **Warranty-** Our products come with an industry-leading 20-year warranty for indoor use and 10-year warranty for outdoor use.

## COMMON APPLICATIONS

- Tennis Clubs •Pickleball Clubs • Recreation and Fitness Centers • Educational Institutions • Athletic Facilities • Amusement Parks
- Outdoor Installations