

FOREMAN® Athletic Locker - Model: HOCKEY LEAGUE

FRONT VIEW

SIDE VIEW

3D VIEW

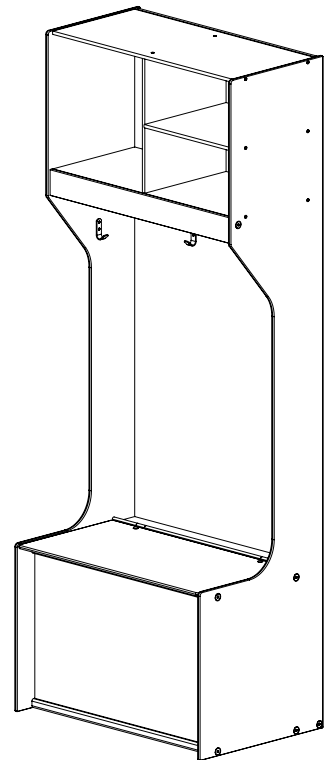
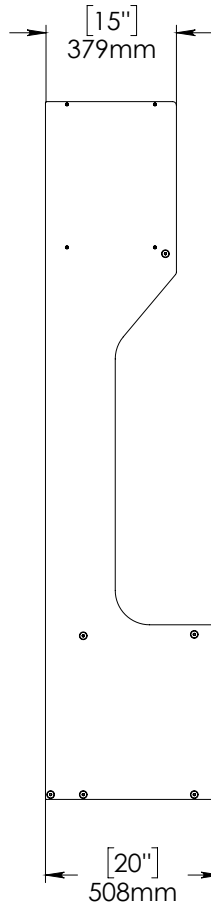
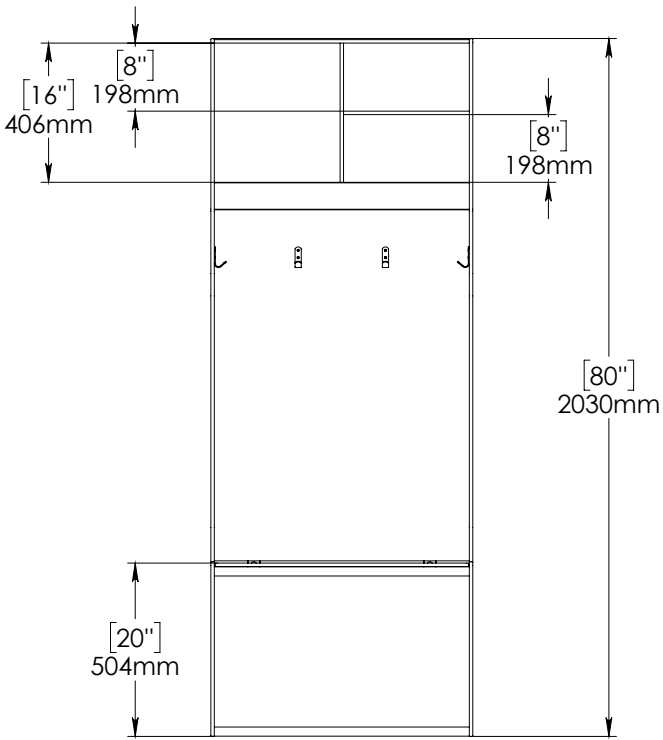

TOP VIEW

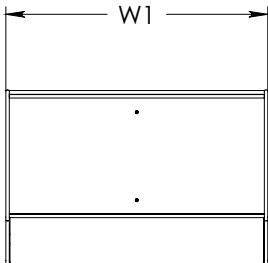

The model HOCKEY LEAGUE #A780XX-NYZ is available in several upper and lower compartment variations.

XX = Width of the locker (Standard widths are 30" and 36")

Y = Configuration of the upper compartment:

"C" = Two Way Split Compartment

"S" = Three Way Split Compartment

Z = Configuration of the lower compartment:

"L" = Full Size Locker with Lift-Up Lid

"D" = Drawer

"C" = Open Cubby

STANDARD SIZE OPTIONS

| OA Width (W1) | 30" | 36" |
|---------------|-------|-------|
| | 762mm | 914mm |



PROPRIETARY AND CONFIDENTIAL

THE INFORMATION CONTAINED IN THIS DRAWING IS THE SOLE PROPERTY OF FOREMAN PRODUCTS LLC. ANY REPRODUCTION IN PART OR AS A WHOLE WITHOUT THE WRITTEN PERMISSION OF FOREMAN PRODUCTS LLC IS PROHIBITED

DESCRIPTION

Athletic Locker - Model: HOCKEY LEAGUE

--

SCALE: --

NAME

DRAWN BY YK

MRG APPR. SL

PAGE 1 of 2

DATE

17.07.24

FOREMAN® Athletic Locker - Model: HOCKEY LEAGUE

Model: HOCKEY LEAGUE #A780-NSL
Features Three Way Split Upper
Compartments and a Full Size Locker
with Lift-Up Lid

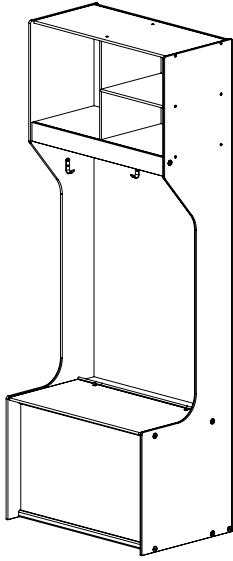

Model: HOCKEY LEAGUE #A780-NSC
Features Three Way Split Upper
Compartments and a Lower Open
Cubby

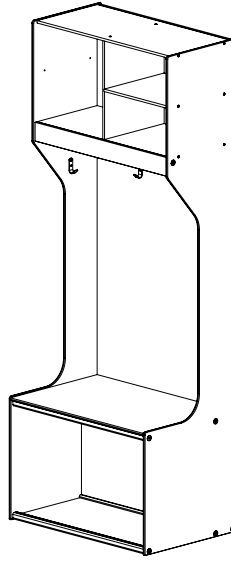

Model: HOCKEY LEAGUE #A780-NSD
Features Three Way Split Upper
Compartments and a Lower Drawer

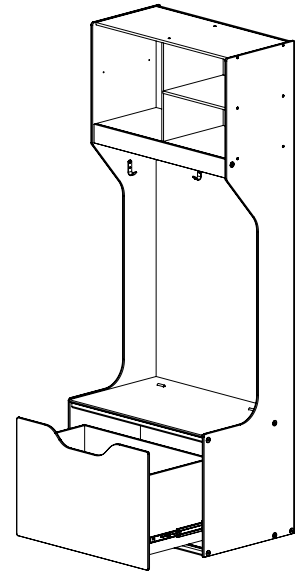

Model: HOCKEY LEAGUE #A780-NCL
Features Two Way Split Upper
Compartments and a Full Size Locker
with Lift-Up Lid

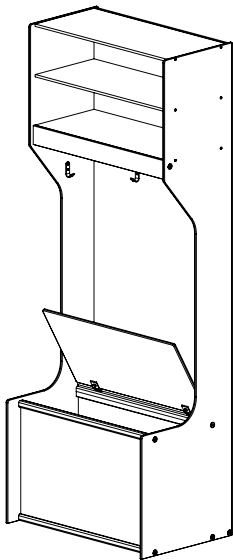

Model: HOCKEY LEAGUE #A780-NCC
Features Two Way Split Upper
Compartments and a Lower Open
Cubby

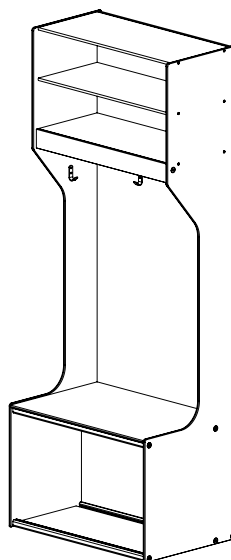

Model: HOCKEY LEAGUE #A780-NSD
Features Two Way Split Upper
Compartments and a Lower Drawer

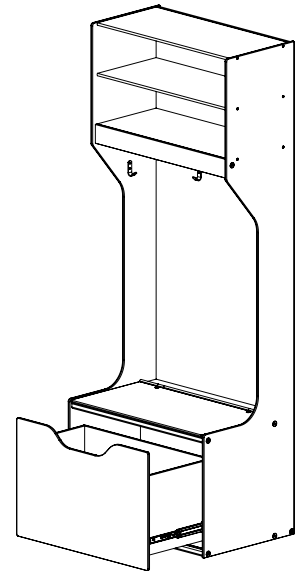

| PROPRIETARY AND CONFIDENTIAL | DESCRIPTION | NAME | DATE |
|---|--|-------------|-------------|
| THE INFORMATION CONTAINED IN THIS DRAWING IS THE SOLE PROPERTY OF FOREMAN PRODUCTS LLC. ANY REPRODUCTION IN PART OR AS A WHOLE WITHOUT THE WRITTEN PERMISSION OF FOREMAN PRODUCTS LLC IS PROHIBITED | Athletic Locker - Model: HOCKEY LEAGUE | DRAWN BY | YK 17.07.24 |
| | -- | MRG APPR. | SL |
| | SCALE: -- | PAGE 2 of 2 | |

Our athletic lockers feature durable and versatile structural elements to ensure long-lasting use. Each model offering convenient upper and lower storage available in multiple design variations to meet the needs of every athlete.

DESIGN VARIATIONS

Upper Compartment • Two Way Split Open Cubbies • Three Way Split Open Cubbies

Lower Compartment • Full Size Locker with Lift-Up Door • Full Size Cubby • Drawer

*All models may be customized to match individual design specifications.

STANDARD CONSTRUCTION ELEMENTS

*measurements expressed in (inches or ")

Dimensions: Width: 30", 36" | Depth: 20" | Height: 80"

Door Opening: 180° with 6063 T6 Aluminum Anodized Profile Integrated Hinges

Body Material: High Pressure Laminate ; Aluminum Framework ; Stainless Steel Hardware

Framework Details: Extruded 6063 T6 Aluminum Anodized Frame with Integrated Hinges and Stainless Steel Bolts

Material Thickness: 3/8"

FEATURES

- **Water Resistant & Non-Corroding-** Built to withstand water exposure, making them ideal for humid environments such as aquatic centers, swimming pools, and showers.
- **Indoor / Outdoor Use-** Built to withstand heavy impact, scratches, graffiti, and chemicals. Optional UV protected panels are available for outdoor use.
- **Ventilation-** 360° 3mm gap around doors for increased ventilation with optional wire mesh vent.
- **Clothes Bar and Hooks-** (4) J Hooks and (1) Clothes Bar
- **High-End Customization Options-** Optional features include tempered glass and side-mounted aluminum channels for hard-wired RFID locks and conveniently placed USB chargers and/or LED lighting.
- **Stock Colors** - Choose from a curated list of our most popular color options by leading phenolic suppliers.
*Choosing from our stock colors may help expedite lead times.
- **Bench Height-** The bench is built at a 20" height, 2" taller than standard, for added comfort while wearing ice skates.
- **Extensive Lock Options-** We provide a wide selection of lock types and can integrate additional lock options to meet specific requirements.
- **Number Plates-** Adhesive mounted 3M brushed aluminum plates with black etched reveal.
- **Ships Assembled-** Athletic Lockers arrive pre-assembled for quick, hassle-free installation, ensuring consistent quality, and structural integrity.
- **Filler Panels-** Filler panels close gaps between lockers and walls for a seamless, professional quality finish.
- **Warranty-** Our products come with an industry-leading 20-year warranty for indoor use and 10-year warranty for outdoor use.

COMMON APPLICATIONS

- Ice Skating Rinks • Hockey Clubs • Recreation and Fitness Centers • Aquatic Parks • Educational Institutions • Athletic Facilities
- Amusement Parks • Corporate Offices and Executive Workspaces • Government Facilities • Military Bases • Outdoor Installations