

FOREMAN® MODULAR ATHLETIC LOCKER FULL SIZE CUBBY

FRONT VIEW

SIDE VIEW

3D VIEW

UPPER COMPARTMENT

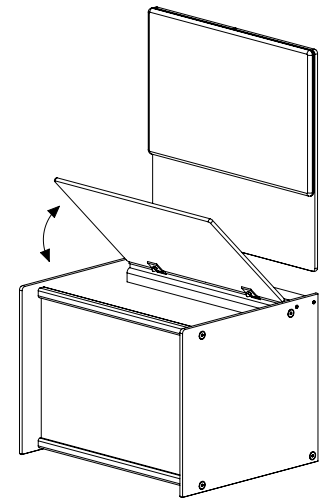
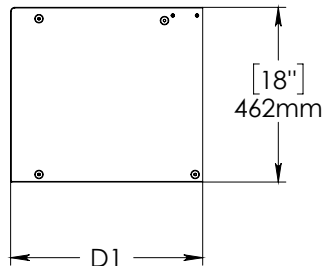
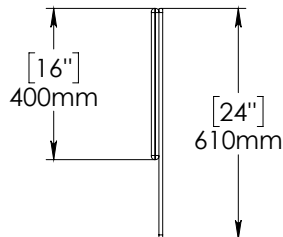
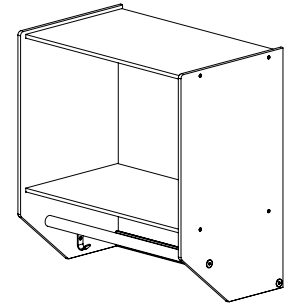
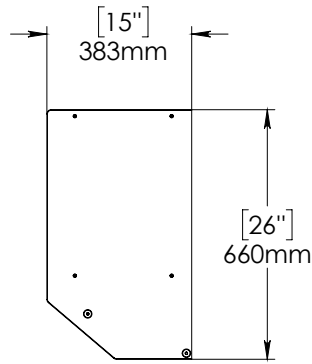
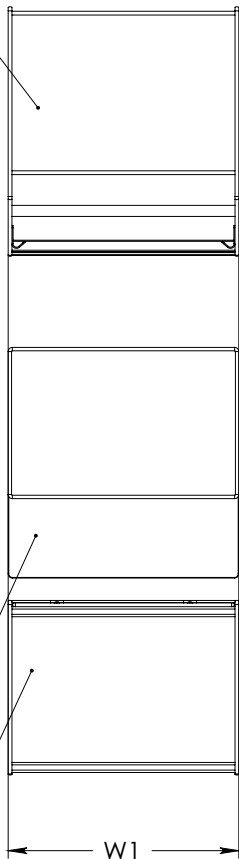

LOWER CHEST WITH LIFT-UP LID

BACK SUPPORT WITH UPHOLSTERED PAD

ADDITIONAL OPTION FOR UPPER COMPARTMENT

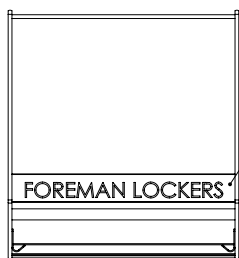

NAME PLATE

STANDART SIZE OPTIONS

	15"	18"	21"	24"	28"	30"	32"
OA Width (W1)	381mm	457mm	533mm	610mm	711mm	762mm	813mm
OA Depth (D1)	18"	20"	24"	-	-	-	-
	457mm	508mm	610mm	-	-	-	-



PROPRIETARY AND CONFIDENTIAL

THE INFORMATION CONTAINED IN THIS DRAWING IS THE SOLE PROPERTY OF FOREMAN PRODUCTS LLC. ANY REPRODUCTION IN PART OR AS A WHOLE WITHOUT THE WRITTEN PERMISSION OF FOREMAN PRODUCTS LLC IS PROHIBITED

DESCRIPTION

Single Free Standing Bench

SCALE: --

NAME

DRAWN BY YK

MRG APPR. SL

DATE

26.04.24

PAGE 1

FOREMAN® MODULAR ATHLETIC LOCKER SPLIT COMPARTMENT FOR A CUBBY

FRONT VIEW

SIDE VIEW

3D VIEW

UPPER COMPARTMENT

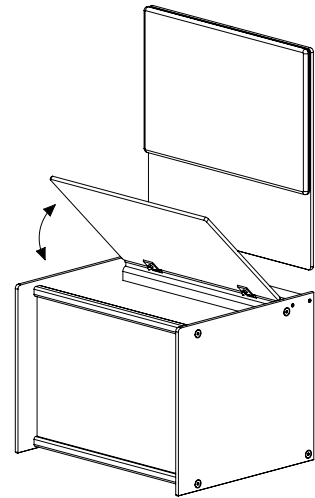
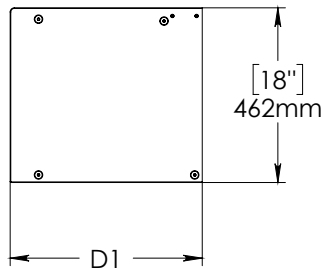
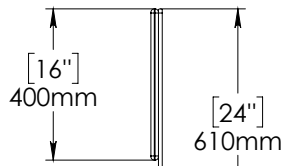
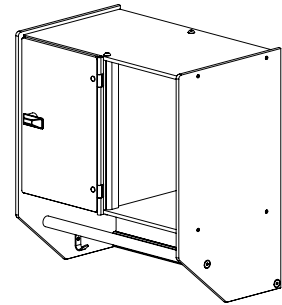
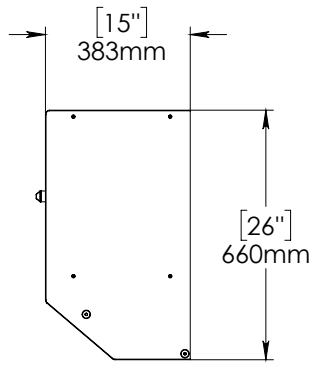
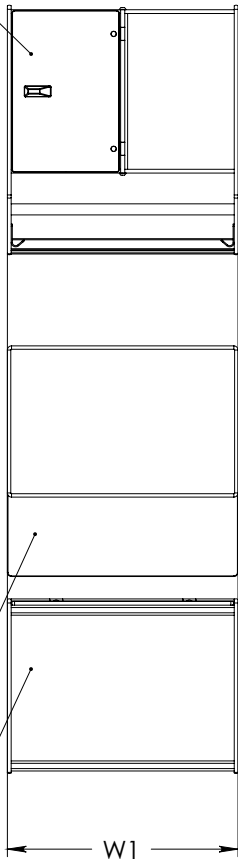

LOWER CHEST WITH LIFT-UP LID

BACK SUPPORT WITH UPHOLSTERED PAD

STANDART SIZE OPTIONS

	15"	18"	21"	24"	28"	30"	32"
OA Width (W1)	381mm	457mm	533mm	610mm	711mm	762mm	813mm
OA Depth (D1)	18"	20"	24"	-	-	-	-
	457mm	508mm	610mm	-	-	-	-

Our athletic lockers feature durable and versatile structural elements to ensure long-lasting use. Each model offering convenient upper and lower storage available in multiple design variations to meet the needs of every athlete.

DESIGN VARIATIONS

Upper Compartment • Two Way Split Open Cubbies • Three Way Split Open Cubbies • Split Compartment with (1) Cubby and (1) Locker
• Full Size Open Cubby

Lower Compartment • Full Size Locker with Lift-Up Door

*All models may be customized to match individual design specifications.

STANDARD CONSTRUCTION ELEMENTS

*measurements expressed in (inches or ")

Dimensions: Width: 15", 18", 21", 24", 28", 30", 32 | Depth: 20", 24", 28" | Height: 71", 80"

Door Opening: 180° with 6063 T6 Aluminum Anodized Profile Integrated Hinges

Body Material: High Pressure Laminate ; Aluminum Framework ; Stainless Steel Hardware

Framework Details: Extruded 6063 T6 Aluminum Anodized Frame with Integrated Hinges and Stainless Steel Bolts

Material Thickness: 3/8"

FEATURES

- **Water Resistant & Non-Corroding-** Built to withstand water exposure, making them ideal for humid environments such as aquatic centers, swimming pools, and showers.
- **Indoor / Outdoor Use-** Built to withstand heavy impact, scratches, graffiti, and chemicals. Optional UV protected panels are available for outdoor use.
- **Ventilation-** 360° 3mm gap around doors for increased ventilation.
- **Clothes Bar and Hooks-** (2) J Hooks and (1) Clothes Bar
- **High-End Customization Options-** Optional features include tempered glass and side-mounted aluminum channels for hard-wired RFID locks and conveniently placed USB chargers and/or LED lighting.
- **Stock Colors -** Choose from a curated list of our most popular color options by leading phenolic suppliers.
*Choosing from our stock colors may help expedite lead times.
- **Three Piece Modular Design-** The modular design features an upper storage unit, a back support panel unit, and a lower storage unit.
- **Extensive Lock Options-** We provide a wide selection of lock types and can integrate additional lock options to meet specific requirements.
- **Number Plates-** Adhesive mounted 3M brushed aluminum plates with black etched reveal.
- **Ships Assembled-** Athletic Lockers arrive pre-assembled for quick, hassle-free installation, ensuring consistent quality, and structural integrity.
- **Filler Panels-** Filler panels close gaps between lockers and walls for a seamless, professional quality finish.
- **Warranty-** Our products come with an industry-leading 20-year warranty for indoor use and 10-year warranty for outdoor use.

COMMON APPLICATIONS

- Sports Clubs • Recreation and Fitness Centers • Aquatic Parks • Educational Institutions • Athletic Facilities • Amusement Parks
- Corporate Offices and Executive Workspaces • Government Facilities • Military Bases • Outdoor Installations