

FOREMAN® 2-Tier Open Cubbies

FRONT VIEW

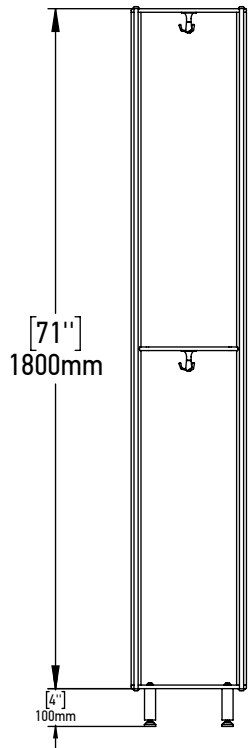

SIDE VIEW

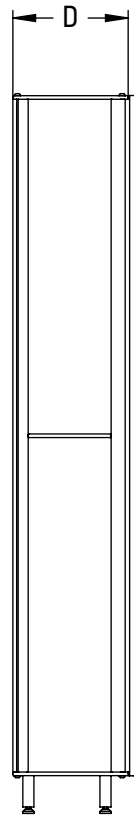

3D VIEW

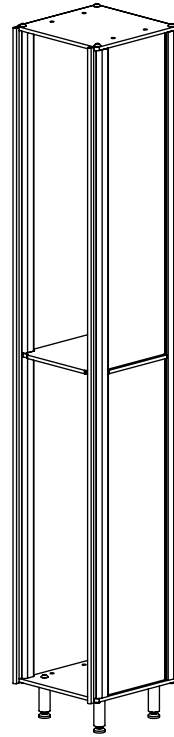

TOP VIEW

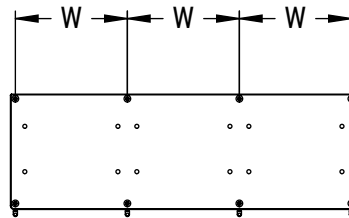
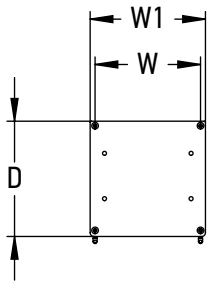

STANDARD SIZE OPTIONS

	9"	12"	15"	18"
Width CTC (W)	228mm	305mm	381mm	457mm
OA Width (W1)	10"	13"	16"	19"
	254mm	331mm	407mm	483mm
Depth (D)	12"	15"	18"	20"
	305mm	381mm	457mm	504mm

FOREMAN[®]
locker systems

PROPRIETARY AND CONFIDENTIAL

THE INFORMATION CONTAINED IN THIS DRAWING IS THE SOLE PROPERTY OF FOREMAN PRODUCTS LLC. ANY REPRODUCTION IN PART OR AS A WHOLE WITHOUT THE WRITTEN PERMISSION OF FOREMAN PRODUCTS LLC IS PROHIBITED

DESCRIPTION

2-Tier Open Cubbies

--

SCALE: 1:20

NAME DATE

DRAWN BY YK 16.09.25

MRG APPR. SL

PAGE 1