

FOREMAN Athletic Locker - Model: MVP 72" High

INTERIOR VIEW
WITHOUT DOOR

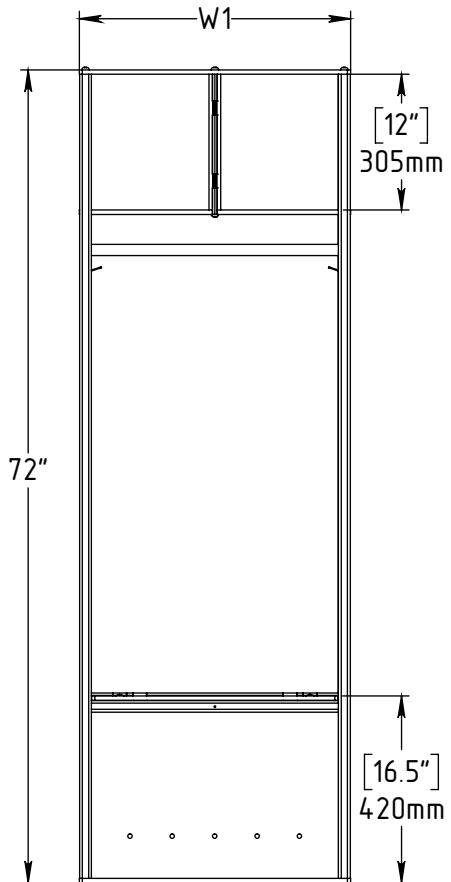

SIDE VIEW

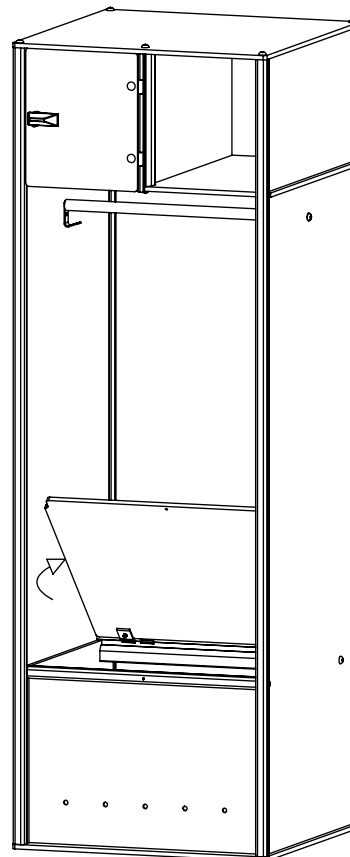
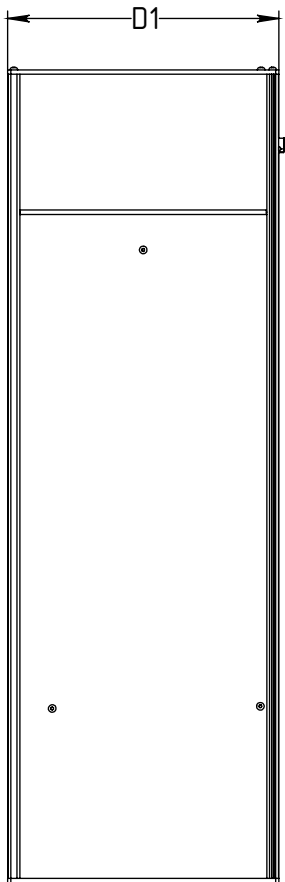

TOP VIEW

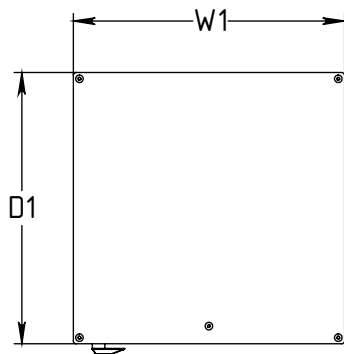

The model MVP A572XX-NYZ is available in several widths with three different configurations for the upper and lower compartments.

XX = Width of the locker (Standard widths are 18" and 24")

Y = Configuration of the upper compartment and can be substituted by:

"C" = Open Cubby

"S" = Split Compartment (Half-wide Lockable Safe and Half-wide Open Cubby).

Z = Configuration of the lower compartment and can be substituted by:

"L" = Full Size Locker with Lift-Up Lid

"C" = Open Cubby

AVAILABLE SIZES

OA Width (W1)	18"	24"
	457mm	610mm
OA Depth (D1)	18"	24"
	457mm	610mm



PROPRIETARY AND CONFIDENTIAL
THE INFORMATION CONTAINED IN THIS DRAWING IS THE SOLE PROPERTY OF FOREMAN PRODUCTS LLC. ANY REPRODUCTION IN PART OR AS A WHOLE WITHOUT THE WRITTEN PERMISSION OF FOREMAN PRODUCTS LLC IS PROHIBITED

DESCRIPTION	NAME	DATE
Athletic Locker - Model: MVP 72" High	DRAWN BY KB	12.12.2020
--	MRG APPR. NB	--
SCALE: --	Page 1 of 3	

FOREMAN Athletic Locker - Model: MVP 72" High

Model: MVP #A572XX-NCC
Unit features an Upper Open Cubby and a Lower Open Cubby

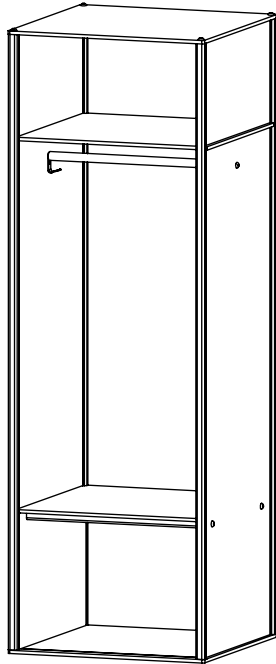

Model: MVP #A572XX-NSC
Unit features an Upper Safe and Small Cubby and a Lower Open Cubby

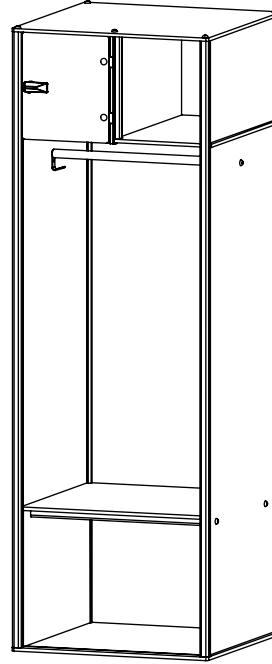

Model: MVP A572XX-NCL
Unit features an Upper Open Cubby and a Lower Chest with Lift-up Seat

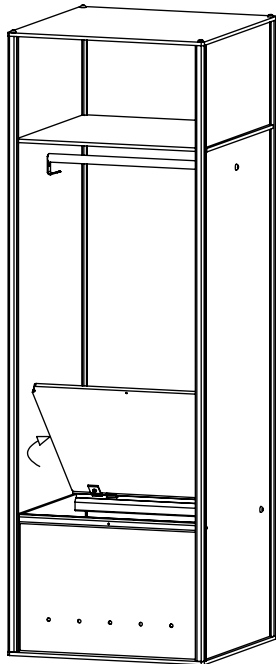

Model: MVP A572XX-NSL
Unit features an Upper Safe and Small Cubby and a Lower Chest with Lift-up Seat

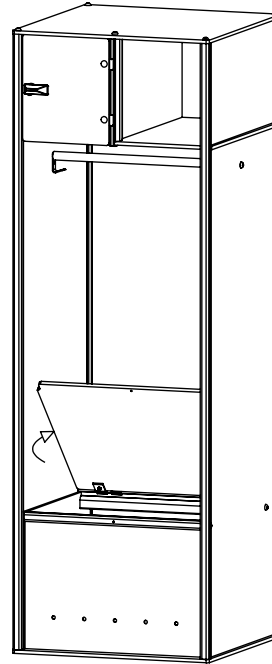

FOREMAN[®]
locker systems

PROPRIETARY AND CONFIDENTIAL

THE INFORMATION CONTAINED IN THIS DRAWING IS THE SOLE PROPERTY OF FOREMAN PRODUCTS LLC. ANY REPRODUCTION IN PART OR AS A WHOLE WITHOUT THE WRITTEN PERMISSION OF FOREMAN PRODUCTS LLC IS PROHIBITED

DESCRIPTION

Athletic Locker - Model: MVP 72" High

--

SCALE:

--

NAME

DRAWN BY
KB

MRG APPR.

NB

Page 2 of 3

DATE

12.12.2020

--

We incorporate the best materials and latest features to meet modern requirements of the industry resulting in a bestselling product line. Our versatile construction design allows for a vast choice of sizes and configurations. Our unique extruded aluminum profile allows us to utilize the material in a highly efficient manner. The construction of MVP model uses FOREMAN® vertical aluminum 2-channel profile throughout the full height of the locker for using 1/8" thick solid phenolic for the side and back panels. All other horizontal panels are made out of standard 3/8" (10mm) thick phenolic material secured with stainless steel hardware. This brought an extremely pricey product back down to an affordable level. Typically the lockers ship unassembled leading to significant savings for long distance shipping within the US or even worldwide. Assembling the Lockers does not require a professionally trained staff. The detailed installation manual and instructional video easily demonstrates how the locker are assembled. FOREMAN® lockers are constructed with Stainless Steel flush mounted bolts (Countersunk) so the lockers join together seamlessly.

FEATURES:

FOREMAN® Athletic MVP locker is 24" wide and 72" high. It may have 18" or 24" depth. Currently there are (2) basic configurations of the upper compartment: open cubby or a spilt shelf with a safe and small cubby and (2) configurations for the lower compartment: open cubby or a lockable chest. We also offer an open space for an ice-hockey model.

INCLUDES:

- Modern HÄFELA Hardware
- Standard Aluminum Clothes Bar
- (2) Wall-Mounted Hooks (Hook Options Available).
- Hasps for Pad Lock (On lower compartment when the chest option is selected).
- Wide selection of colors by major HPL Manufacturers
- STOCK COLORS (For Faster Delivery) - White, Pastel Grey, Dark Grey Charcoal Grey, Black
- STOCK WOOD GRAIN COLORS: (For Faster Delivery) Tosca, Maple, Cello, Monte by FUNDERMAX®
- Two-Color Design (For face and side panel).
- Water Resistant - (The material withstands humid areas or direct water (valuable for installations near showers and cleaning).
- Large Selection of Lock Options
- Unique 20 Year Warranty

OPTIONAL FEATURES

- Upholstered Seat Pad
- Debossed, Sewn or Imprinted Custom Logo on the Seat Pad
- Engraved and Acrylic Filled Custom Logo on a Door
- Gas Spring for a Soft Close Seat
- Custom colors for the Aluminum Profile
- Polycarbonate (or Tempered Glass) Doors - Great for Cheerleader Lockers.
- LED-light and USB Charger.
- Side-mounted Aluminum Channels for: Hard-Wired RFID-Locks or USB-charges (Conveniently located side-mounted versus back panel location).
- Thicker Material (1/2", 5/8" or 3/4") is available upon request to match the specification.

CONSTRUCTION:

- Doors with Finished Radius Edges
- Aircraft Quality Aluminum Profiles with Integrated Hinges
- 3/8" or Optional 1/2" Solid Phenolic Doors and Shelves
- 3/8" Solid Phenolic Walls and Back Panels (Thicker material is available to meet specifications)
- Standard Aluminum Clothes bar
- 3M Brushed Aluminum Number Plate
- Standard Double Eyelet for Padlock for the Chest option

APPLICATIONS:

- Sports Complexes
- Recreational Facilities
- Universities, Colleges and High Schools
- Fitness Centers
- Military Facilities
- Stadiums
- Training Facilities.